

FLOW #	TAG #	SOLENOID ENERGIZED
1.02	XCV1055	TO OPEN
3.02	XCV2055	TO OPEN

- 8 - BTM SW C > CLOSED
- 7 - BTM SW NC > CLOSED
- 6 - TOP SW C > OPEN
- 5 - TOP SW NC > OPEN
- 4 - SOL PWR 2
- 3 - SOL PWR 1
- 2 - SOL 2
- 1 - SOL 1

11³/₄"

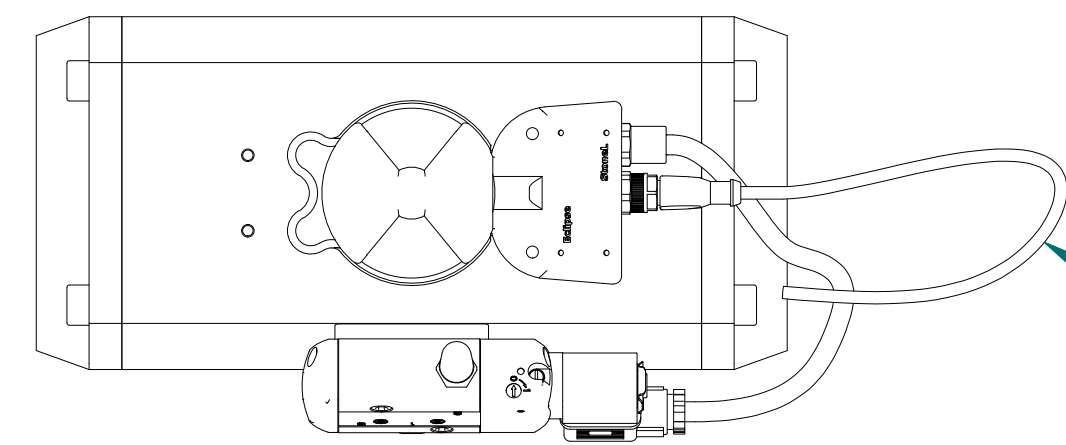

TO TERMINATION
FIELD JUNCTION BOX
(BY OTHERS)

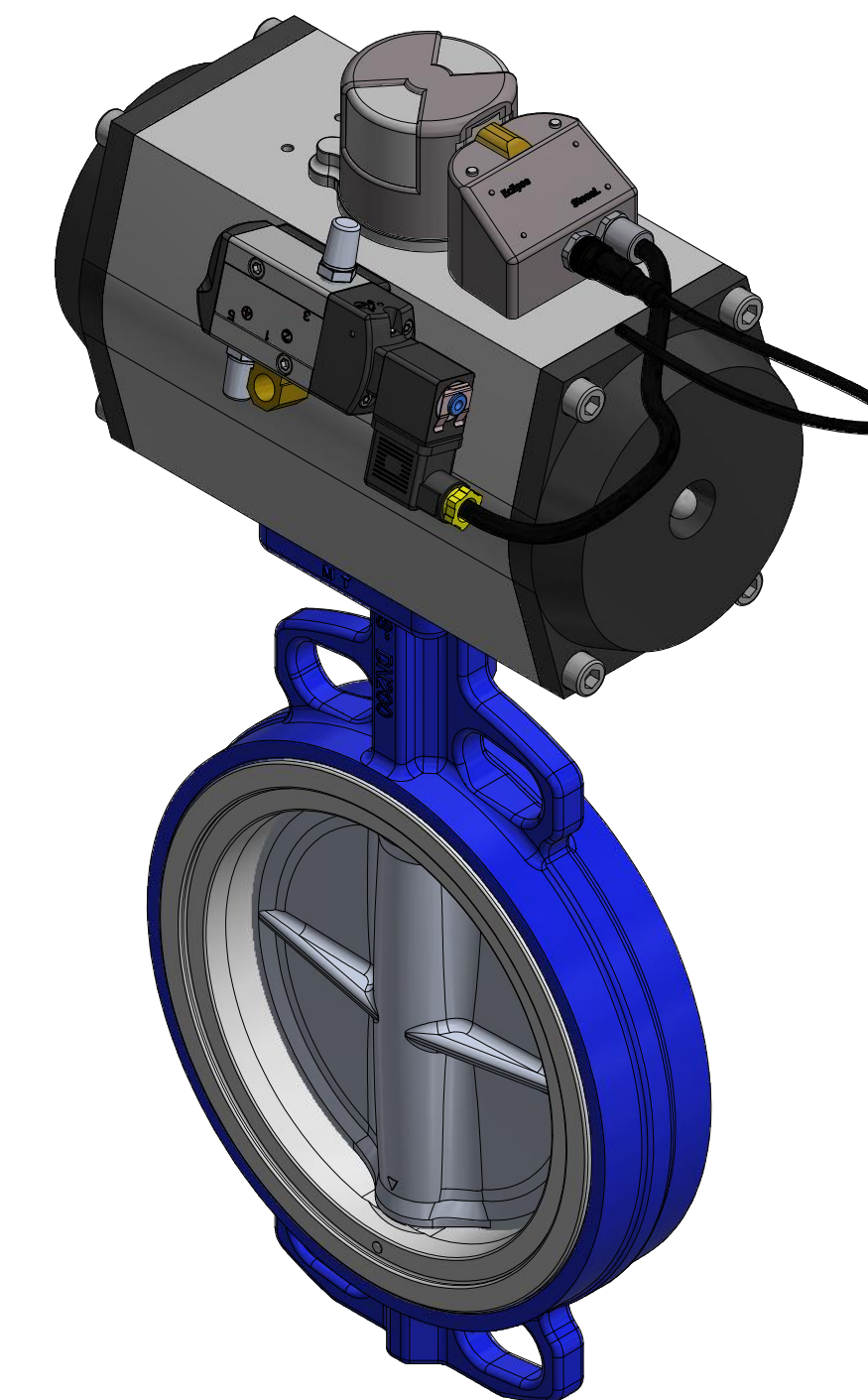
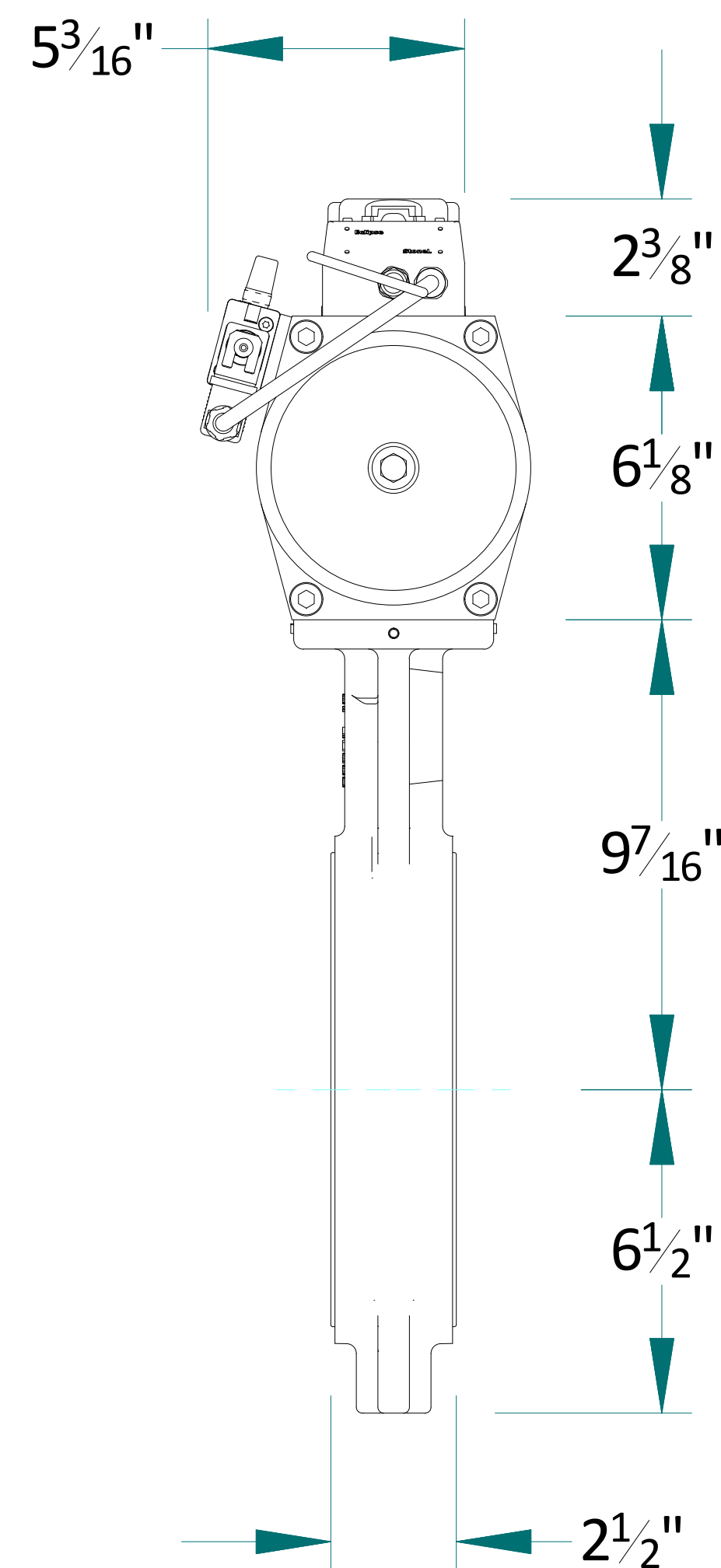
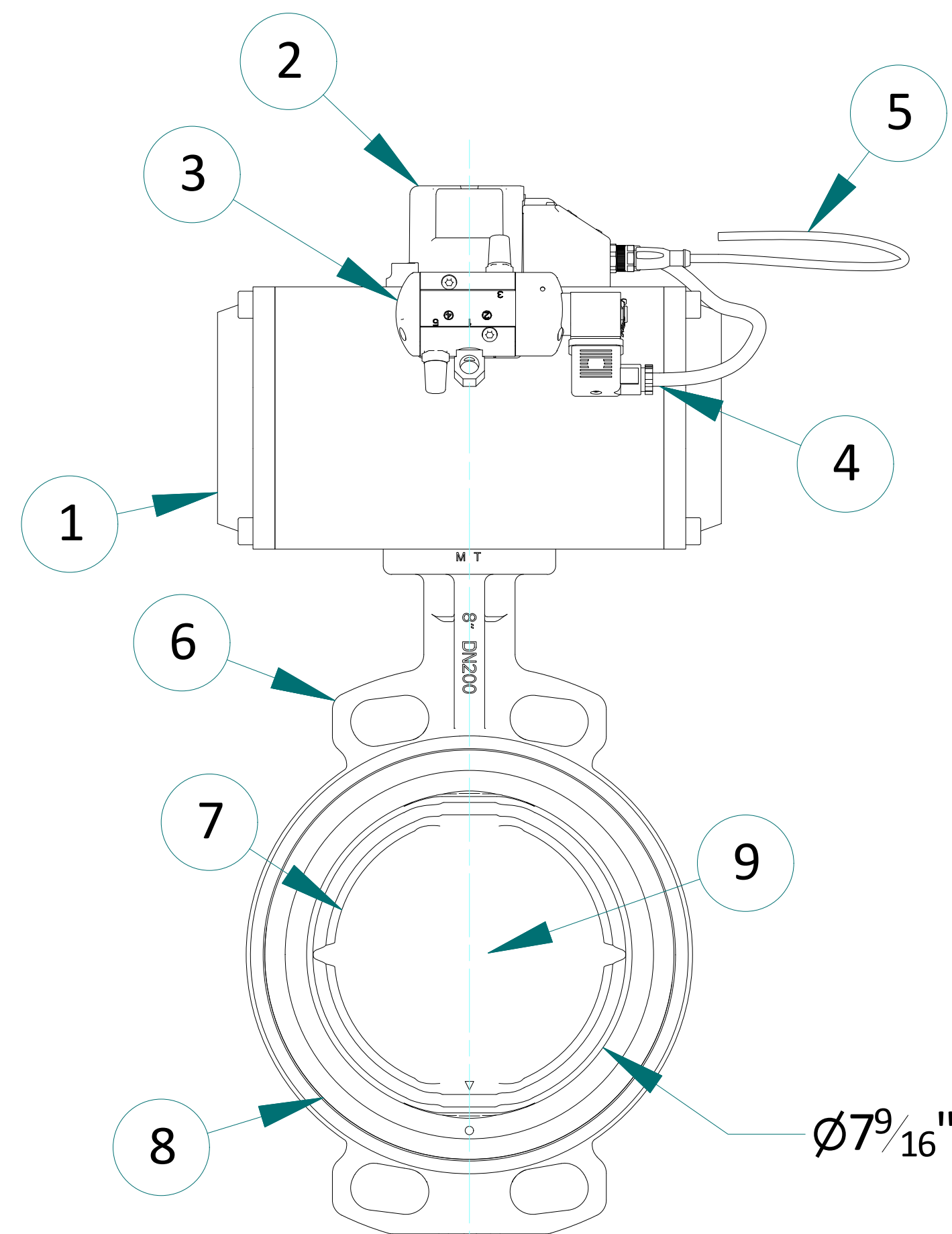

NOTES:

- ALL DIMENSIONS ARE IN INCHES UNLESS NOTED OTHERWISE
- APPROX. WEIGHT: 53 LBS

COMPONENT LIST			
ITEM	QTY	DESCRIPTION	PART NUMBER
1	1	ACTUATOR	RPB250DA
2	1	LIMIT SWITCH	STONEL ECLIPSE EG EG33P26DM-MMMM05, 24VDC
3	1	SOLENOID VALVE	ASCO SC8551A001MS 24/DC
4	1	ELECTRICAL CONNECTOR	ASCO 290414-001
5	1	M12 MOLDED CHORDSET	WOODHEAD 1200650523, 5 PIN, MALE, 6.5'
6	1	BODY	PAINTED CAST IRON
7	1	DISC	316 STAINLESS STEEL
8	1	SEAT	WHITE EPT, FOOD GRADE
9	1	STEM	316 STAINLESS STEEL



Mac Process - Schenck-AccuRate - Cycle Process
THIS MATERIAL IS THE PROPERTY OF MAC PROCESS, INC. AND SHOULD NOT BE REPRODUCED, PUBLISHED OR DISCLOSED TO ANY OTHER PARTY WITHOUT THE WRITTEN PERMISSION OF MAC PROCESS, INC.

8" VF-730 BUTTERFLY VALVE
MARS WRIGLEY CONFECTIONERY
TOPEKA, KS



NOTE: UNLESS OTHERWISE SPECIFIED DIMENSIONS ARE IN INCHES
TOLERANCES: DECIMAL: ±.005 FRACTION: ±1/16" OVERALL: ±.0015"
PROJECT #: VK-1100101733-1
DRAWING #: 101733301 SHEET #: 1 OF 1
SCALE ON "D" SIZE PAPER: 1/3 REVISION: A

REV	DATE	DESCRIPTION
A	03/06/19	ORIGINAL RELEASE